

## MEL 250L High-resolution LED Sector Light

The MEL250L is a High-resolution Sector Leading Light, whose light source is made of high-intensity **LED technology**. Designed for port accessing channels during day and night as a single and complete leading station.

Light emission generates a highly defined sectorised unidirectional beam with a horizontal divergence between 3° and 15°. Light beam colour sector configuration is expressly done for every case, and always according to IALA Recommendations and Guidelines.

The great accuracy in every sector boundary (<0.07°) provides exact directional information to mariners.

F  
E  
A  
T  
U  
R  
E  
S

### Optical System

- Nominal visibility day range: 0.9 n.m. (T = 0.74).
- Nominal visibility night range: 12.0 n.m. (T = 0.74).
- Aspheric condenser glass lens.
- High-precision optical system stabilised against vibrations.
- Accuracy: 0.07° (4' of arc).
- Adjustable vertical divergence.
- Fixed light, flashing, isophase or occulting flash characters.
- Taylor-made colour sector degrees.

### Light Source

- Light source formed by a 3 high-intensity LED lamps, of 9W power.
- LED average life time: 100,000 hours.



### Electronic Control

- MF 12 Solid-state flasher.
- Microprocessor controlled circuit.
- Easy programming by micro-switches.
- Input voltage: from 12V to 35V DC.
- Day/night control.
- LED current control.
- Ready for remote control by RS-232.
- High-precision led power regulation (PWM).
- Automatic reduction of luminous intensity in night mode.
- Reverse-polarity and short-circuit protection.
- Transient-overvoltage protection.
- Overtemperature protection.

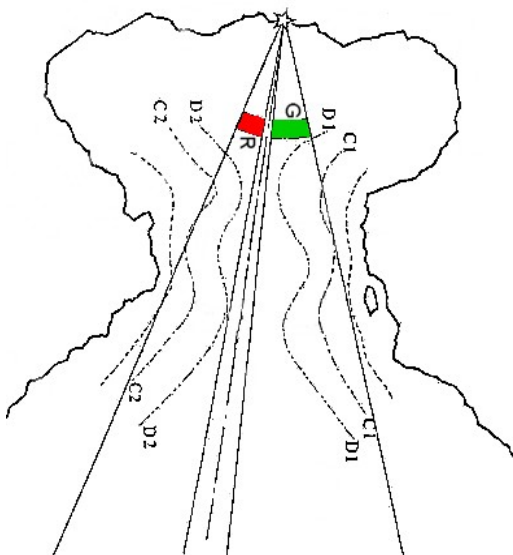

## MEL 250L High-resolution LED Sector Light

### Others

- Chassis made from stainless steel and aluminium.
- Outer painting with Teflon coating.
- Inner painting resistant to high temperatures.
- Levelling system at the base.
- Eyeshade to avoid reflections.
- Stainless-steel hardware.
- Fixing: 4 nos. off M10 bolts.
- Protection class: IP 66.
- Electromagnetic compatibility  $\text{CE}$ .

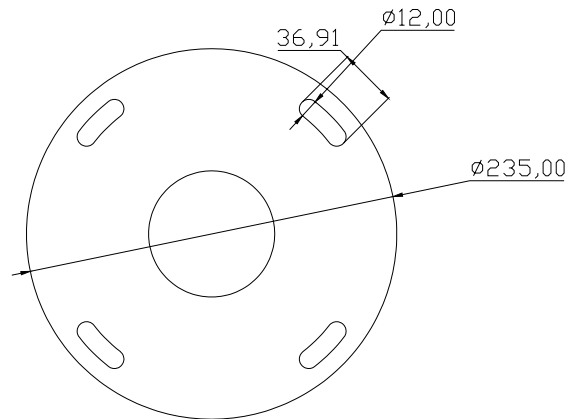

### Options

- Oscillating boundaries.
- Telescopic visor.
- AC operation.
- GPS synchroniser-flasher.

MEL 250L	Physical Data
	Div 15°
Length (mm)	460
Width (mm)	260
Height (mm)	305
Net Weight (Kg)	10
Packing (mm)	700 x 500 x 500
Gross Weight (Kg)	15

MEL 250L	Stationary Intensities	
		Horizontal Divergence (Total)
	Colour	15°
9W LED Source	White	3,600
	Red	1,850
	Green	2,130

